

## Ventilation Equipment

### 304 S\_S Island Hood+Filters+Lamps 2400x2600mm

ITEM # \_\_\_\_\_

MODEL # \_\_\_\_\_

NAME # \_\_\_\_\_

SIS # \_\_\_\_\_

AIA # \_\_\_\_\_



640239 (STCF2624)

 304 stainless steel Island  
 Hood with filters and lamps

### Short Form Specification

Item No. \_\_\_\_\_

Compensating-Flow Exhaust System (air inlet from outdoors). Manufactured in two pieces. Constructed in 304 AISI stainless steel. Equipped with labyrinth filters in 304 AISI stainless steel, blind panels in 304 AISI stainless steel, fluorescent lights, grease collecting trough all around and condensate collecting tray.

### Main Features

- External panels with upturned edges to avoid injuries.
- Heating and air conditioning costs reduced thanks to the compensated air flow.
- Low noise level.

### Construction

- Outlet holes are sized in order to minimize drops in pressure.
- Labyrinth filters guarantee constant filtration to avoid clogging and to protect against fire.
- 304 AISI stainless steel labyrinth filters easily removable for cleaning.
- Built-in lighting with protective screen.
- Optional accessory: air intake Plenum, which is insulated to avoid condensation.
- Rear exhaust with filters and front air intake through a narrow slot sized to obtain the correct induction effect.
- Perforated panel inside the intake circuit guarantees a perfect and uniform air distribution.
- Completely insulated intake area to avoid external condensation.
- Two separate air circuits (extraction and intake) to reduce the quantity of treated air released in the environment.
- Constructed as 2 separate wall units to join on site back to back.
- Central gutter with drain hole to transfer grease into two 304 AISI containers.
- Entirely constructed in 304 AISI stainless steel.

APPROVAL: \_\_\_\_\_

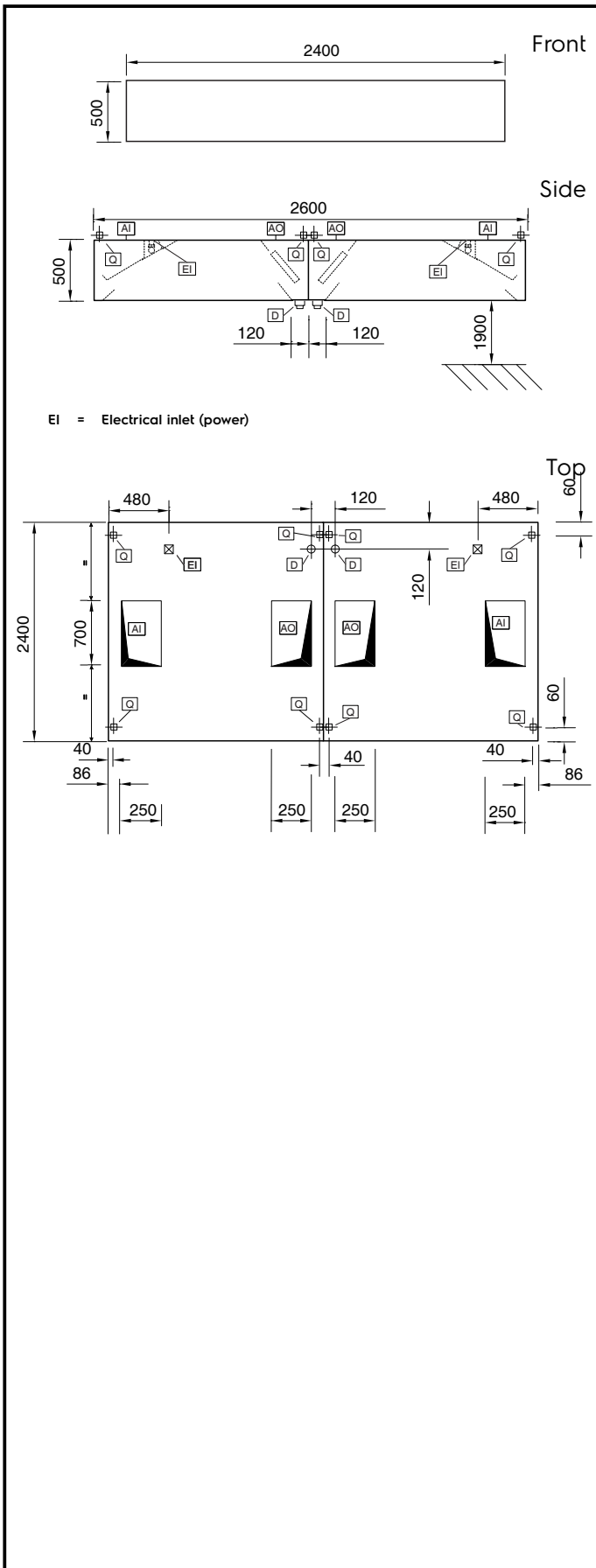

#### Electric

Supply voltage:  
 640239 (STCF2624) 220 V/1N ph/50 Hz  
 Total Watts: 0.32 kW

#### Capacity:

Supply capacity: 0 m<sup>3</sup>/h

#### Key Information:

External dimensions, Width: 2400 mm  
 External dimensions, Depth: 2600 mm  
 External dimensions, Height: 500 mm  
 Net weight: 314 kg

#### Air Emission:

Air capacity: 7900 mc/h